

KEY:

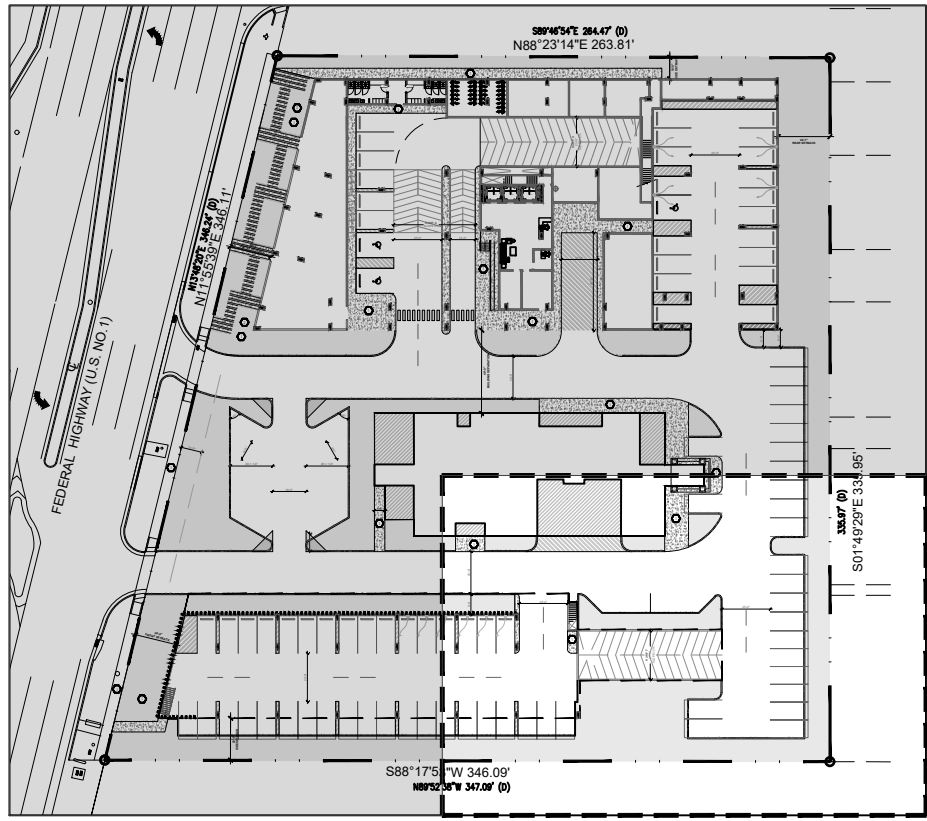

absolute-idea.com
CANAL PARK
3323 NE 163rd Street, Suite 200 North Miami Beach, FL 33160
305.792.0015 305.931.0279 info@absolute-idea.com

SEAL
KEN GARDNER
FLA 1589
TO THE BEST OF MY KNOWLEDGE, THE PLANS AND SPECIFICATIONS COMPLY WITH THE CITY OF MIAMI'S REQUIREMENTS FOR THE PROJECT AND I AM NOT PROVIDING ANY GUARANTEE OR WARRANTY FOR THE SAME. MY RESPONSIBILITY IS LIMITED TO THE DESIGN SERVICES PROVIDED BY ME OR MY FIRM.

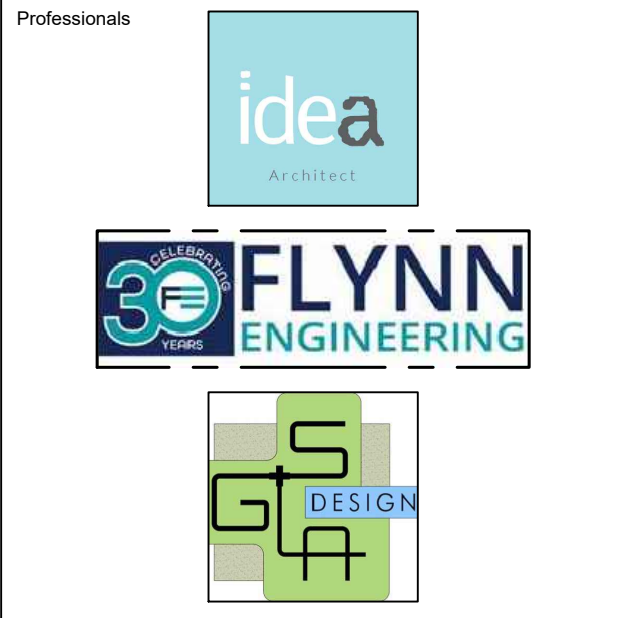

REV.	DATE	DESCRIPTION
01	XX-XX-2024	D.R.C SUBMITAL
DRC		
PZ24-12000027		
04/15/2026		

ALL MEASUREMENTS MUST BE VERIFIED BEFORE BEGINNING THE WORKS. NO MEASUREMENTS ARE TO BE SCALED DIRECTLY FROM THIS DRAWING.

Key section

Client
VERA FUND
NICK POLYUSHKIN
& YURI KHARITONENKOV
TEL: 305.833.3303

Project
**1600 S FEDERAL HIGHWAY
(MIXED-USE PROJECT)**
1600 SOUTH FEDERAL HIGHWAY,
POMPANO BEACH, FL 33062

Title	
PLANTING PLAN - GROUND FLOOR	
Drawn GSLA	Field LANDSCAPE ARCH
Verified KG	Scale as shown
Approved KG	Date 10-09-2024
Project Manager KG	Dwg. no. L-204
Project 24-838	

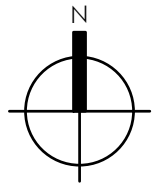

PLANTING PLAN - GROUND FLOOR

SCALE: 1" = 10'